

90755 Top Alcohol 12"  
Modular Assembly

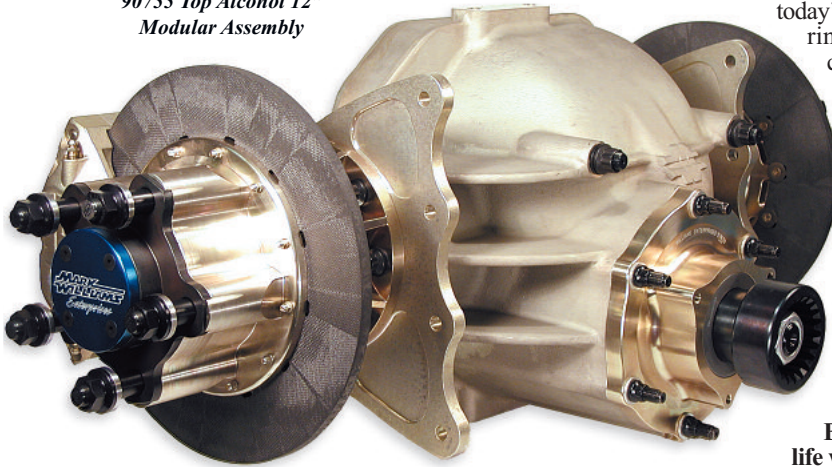

The Mark Williams 12" Modular rear end has been designed to handle the harsh treatment of today's Top Alcohol and Pro Modified cars. This assembly is based on a ring and pinion designed from a clean sheet. It is not like other competitor's efforts to make a stronger unit where their designs are based on existing housing limitations. This unit has the proper proportioning ratios of housing strength and bearing capacity that make it a superior unit.

Features include an 12" Pitch diameter ring gear and 40 spline pinion shaft. The gears are designed with a 12" pitch diameter.

. The gear selection are 2.91, 3.20, 3.70, 3.89, 4.10, 4.29, 4.57, 4.71 and 5.83 ratios.

We currently have the ability to produce special ratios by using our in house the gear blanks.

The special gear ratios can be delivered in approximately 8 weeks.

**Best of all we are so confident in the extended ring and pinion life we warranty the gears against breakage for 2 years.**

The housing can be used with Hi-Torque flange axles as well as the MW Floater Hubs. The unique design allows easy removal of the rear cover to inspect the ring gear, while the removable pinion support gives access to the pinion gear. With the beefy 12" gears, the use of premium materials, and features carried over from the other MW race proven modular rears, the MW 12" offers unmatched strength and reliability.

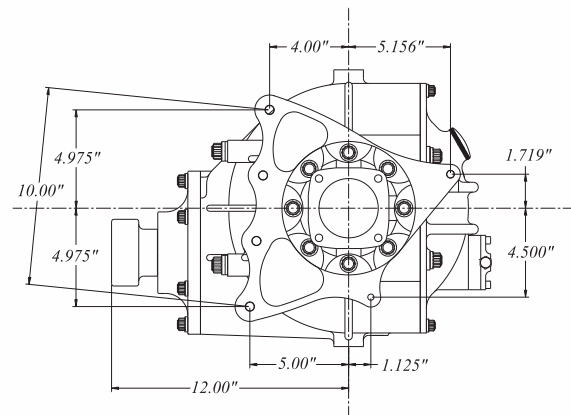
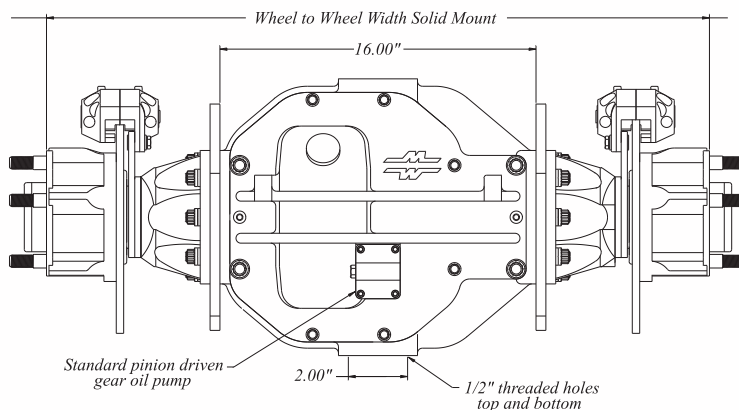

## MODULAR 12" ASSEMBLIES

90000 12" Modular Center Section . . . . .	11,360.00
<i>Fully assembled center section with MW 12" gear, 40 spline aluminum spool, ball-taper pinion support, coupler and hardware. Center section only, use this if you have an existing 9" modular rear and want to upgrade to an 12" gear.</i>	
90750 Complete 12" Modular Steel Brake Assembly . . . . .	17,486.00
<i>Complete 90000 center section with MW 12" gear, 40 spline aluminum spool, ball-taper pinion support, coupler and hardware, and end bells. MW full floater with 40 spline axles. Aluminum solid mount brackets. Includes MW 4 piston calipers and lightened steel brake rotors. 210#</i>	
90755 Complete 12" Modular Carbon/Carbon Assembly . . . . .	18,328.00
<i>Complete 90000 center section with MW 12" gear, 40 spline aluminum spool, ball-taper pinion support, coupler and hardware, and end bells. MW full floater with 40 spline axles. Aluminum solid mount brackets. Includes MW 4 piston calipers and carbon/carbon brake rotors and pads. 198#</i>	

See charts on pages 54 and 55 for solid mount widths and floater spindle combinations. Call for pricing on special widths and combinations.