

INSTALLATION - SERVICE INSTRUCTIONS



Bulletin NO. 0016
PAGE 1 OF 2

June
2002

765 South Pierce Avenue, Louisville, CO 80027 (303) 665-6901 / 800-525-1963

Part Numbers:

58210A....."C" clip eliminator kit for standard GM 10 and 12 bolt rears using stock axles.

Parts Included:

- 2- 58201.....Bearing housing.
- 2- 58202.....Bearing retainer.
- 1- 58504.....Axle bearings, 1.625" I.D.
- 2- 58204.....Bearing lock rings, 1.400" I.D.
- 2- 58205.....Flanged reducer bushing for 1.625" I.D. axle bearing.
- 8- 06434342.....3/8-24 x 2 1/2" Grade 9 bolt.
- 8- 21FC-624.....3/8-24 Self locking nuts.
- 2- -230.....Bearing housing "O" ring.

Primary Applications:

Drag Racing applications using standard passenger car 10 or 12 bolt rear end.

Installation Overview:

- 1) Remove stock axles, bearings and seals from housing. Using a hacksaw or abrasive cut-off wheel, trim housing outboard of backing plate flange to 5/16" to 3/8" (see Diagram B).
- 2) To accommodate the 1.400" diameter of stock axles, the I.D. of the axle bearings are reduced using the supplied flanged bushings (58204). The bushing should be pressed into the bearing with the flange on the outer side of the bearing.
- 3) Slide bearing retainer plates with four bolts in each over the axle shaft. Bolts must be in retainers when installing bearings on stock axles since there is no access hole in the flange to go through after retainers and bearings are in place. Since the stock axles do not have a defined shoulder to stop the bearing as it is pressed on, the dimension shown in Diagram A must be measured as the bearing and lock ring are pressed on. Hold retainer flush against bearing when measuring.
- 4) Before installing axles backing plates must be in place and -230 "O" ring up against the backing plate. Install 58201 bearing housing on the portion of the housing left after trimming (see Diagram B). It may be necessary to clean rust and dirt from the part of the stub that will locate the bearing housing. It may also be necessary to tap the bearing housing on with a plastic mallet. Make sure the holes in the bearing housing, backing plate and the housing flange are all lined up and that the "O" ring is not pinched between bearing housing and backing plate..
- 5) Slide axles into housing, line up bolts in retainer with bearing housing, engage spline and push into position. Install 3/8" nuts and torque to 30-35 ft/lbs.

Torque Specs:

Retainer bolts (3/8-24) 30-35 ft/lbs.

Maintenance Requirements:

Periodic inspection of bearing and check torque on retaining bolts.

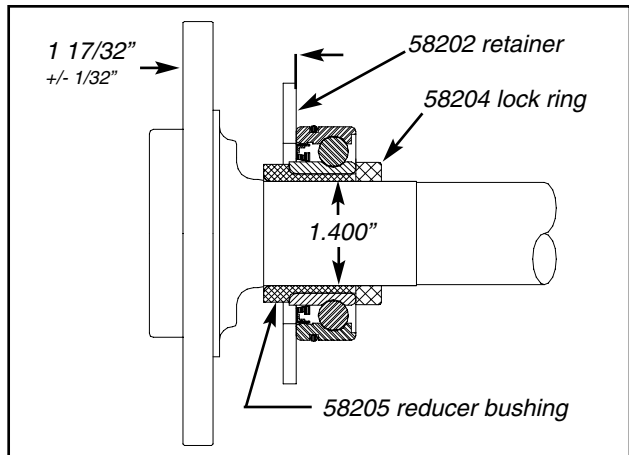

Diagram A

INSTALLATION - SERVICE INSTRUCTIONS

Mark Williams Enterprises

Bulletin NO. 0016

PAGE 2 OF 2

Mark Williams Part No 58210A

ITEM QTY	NAME	DESCRIPTION
1	58204	Lock Ring C-Clip Eliminator Kit
2	Brake Backing Plate	Existing Brake Backing Plate
3	Existing Housing Ends	Existing Axle Tube (must be Modified)
4	Stock Axle	Existing Axle
5	06434342	HEX BOLT
6	21FC-624	HEX NUT
7	58201	Housing for C-Clip Eliminator
8	58504-1	Bearing 1.625" ID, 3.15" OD
9	58202	Retainer For C-Clip Eliminator Kit
10	2-230	O-Ring
11	58205	Bearing to Axle Shim

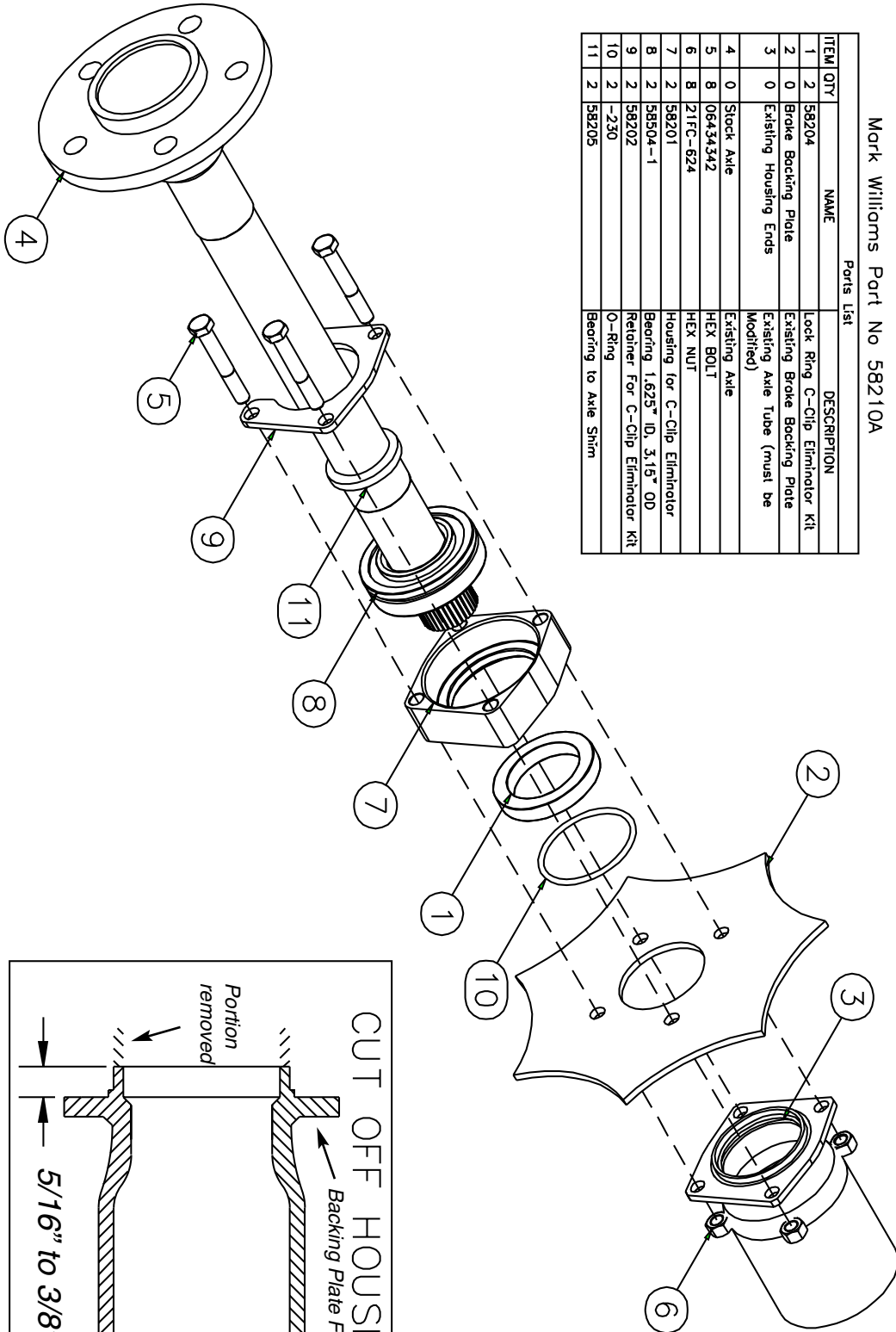

Diagram B